

CUSTOM WATER BOTTLE TUTORIAL



MATERIALS NEEDED

METAL WATER BOTTLE

MASKING TAPE

PENCIL

ACRYLIC PAINT MARKERS

LIGHT COLORED SPRAY PAINT

ACRYLIC SPRAY FINISH

STEP 1:USE MASKING TAPE TO MASK OFF PART OF WATER BOTTLE



STEP 2:

**SPRAY LIGHT COATS OF SPRAY PAINT ONTO
WATER BOTTLE UNTIL THE AREA IS OPAQUE**



STEP 3: REMOVE THE MASKING TAPE AND PENCIL YOUR DESIGN ONTO THE BOTTLE

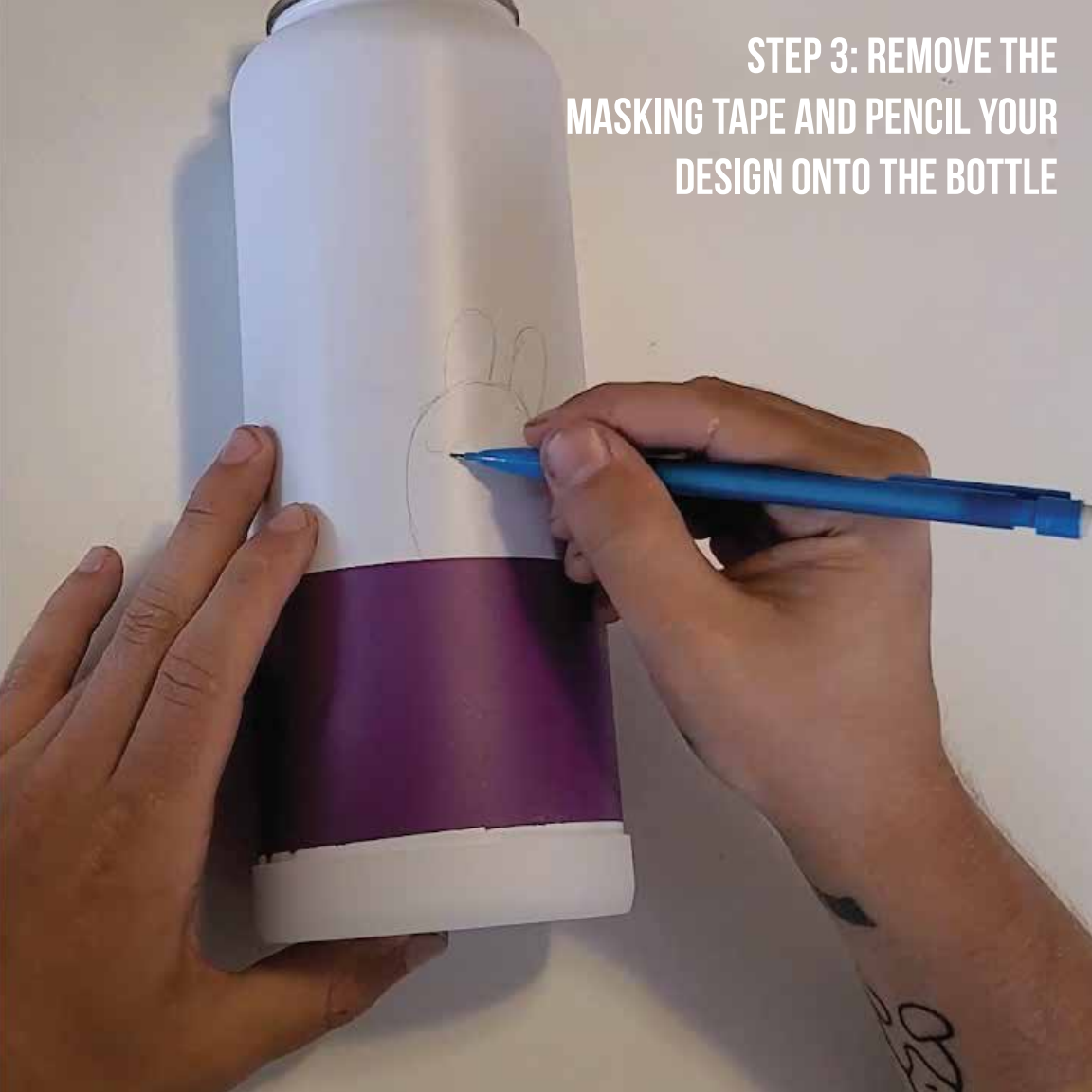

**STEP 4: USE YOUR ACRYLIC
MARKERS TO BEGIN FILLING IN
YOUR DESIGN**



**STEP 5: ONCE YOUR COLORS ARE DRY,
GO THROUGH AND OUTLINE YOUR
DESIGN WITH A BLACK PAINT MARKER**



STEP 6: AFTER THE OUTLINE IS DRY, LIGHTLY SPRAY THE DESIGN WITH YOUR FINISHING SPRAY.



STEP 7: ONCE ITS DRY, ENJOY!